

GENERAL-PURPOSE COMMITTEE CAMPAIGN FINANCE REPORT

FORM GPAC
COVER SHEET PG 1

The GPAC Instruction Guide explains how to complete this form.

1 Filer ID (Ethics Commission Filers)

00060036

2 Total pages filed: Affidavit
5 including A
of Electronic Filing

3 COMMITTEE
NAME

South East Republican Club

4 COMMITTEE
ADDRESS

ADDRESS / PO BOX; APT / SUITE #; CITY; STATE; ZIP CODE

P.O. Box 1286

Mansfield, TX 76063

☐ Change of Address

5 CAMPAIGN
TREASURER
NAME

MS / MRS / MR

FIRST

MI

Mr.

Charles

Thomas

NICKNAME

LAST

SUFFIX

Tom

CORBIN

OFFICE USE ONLY

Date Received

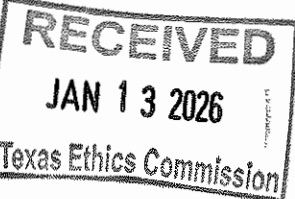

Date Hand-delivered or Date Postmarked

postmarked 1/7/26

Receipt #

Amount \$

Date Processed

1/14/26

Date Imaged

6 CAMPAIGN
TREASURER
STREET ADDRESS
(Residence or Business)

STREET ADDRESS (NO PO BOX PLEASE); APT / SUITE #; CITY; STATE; ZIP CODE

1311 Clubhouse Dr. Mansfield TX 76063

7 CAMPAIGN
TREASURER
MAILING ADDRESS

STREET ADDRESS OR PO BOX; APT / SUITE #; CITY; STATE; ZIP CODE

P.O. Box 237 Mansfield TX 76063

☐ Change of Address

8 CAMPAIGN
TREASURER
PHONE

AREA CODE

PHONE NUMBER

EXTENSION

(817)

475-4815

9 REPORT TYPE



January 15



30th day before election



Dissolution (Attach PAC-DR)



July 15



8th day before election



10th day after campaign treasurer termination



Runoff

10 PERIOD COVERED

Month Day Year

07 / 01 / 2025

THROUGH

Month Day Year

12 / 31 / 2025

11 ELECTION

Local Political
Club Continued

ELECTION DATE

Month

Day

Year

/ /



ELECTION TYPE

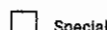

☐ Other Description

GO TO PAGE 2

R: 101032220

GENERAL-PURPOSE COMMITTEE PURPOSE AND TOTALS

FORM GPAC
COVER SHEET PG 2

12 COMMITTEE NAME <u>South East Republican Club</u>		13 Filer ID (Ethics Commission Filers) <u>00066034</u>
14 COMMITTEE ACTIVITY (Attach lists on plain paper to complete this report if necessary.)	1. Candidates (Identify by name or, if applicable, classify by party.)	A. Supported
		B. Opposed
	2. Measures (Describe by date and location of election and nature of issue.)	A. Supported
		B. Opposed
	3. Officeholders Assisted (Identify by name or, if applicable, classify by party.)	
15 CONTRIBUTION TOTALS	1. TOTAL UNITEMIZED POLITICAL CONTRIBUTIONS (OTHER THAN PLEDGES, LOANS, OR GUARANTEES OF LOANS) <input type="checkbox"/> check here if this report qualifies for the higher itemization threshold	\$ <u>-0-</u>
EXPENDITURE TOTALS	2. TOTAL POLITICAL CONTRIBUTIONS (OTHER THAN PLEDGES, LOANS, OR GUARANTEES OF LOANS)	\$ <u>-0-</u>
	3. TOTAL POLITICAL EXPENDITURES OF \$100 OR LESS, UNLESS ITEMIZED	\$ <u>1.40</u>
CONTRIBUTION BALANCE	4. TOTAL POLITICAL EXPENDITURES	\$ <u>193.40</u>
	5. TOTAL POLITICAL CONTRIBUTIONS MAINTAINED AS OF THE LAST DAY OF THE REPORTING PERIOD	\$ <u>-0-</u>
OUTSTANDING LOAN TOTALS	6. TOTAL PRINCIPAL AMOUNT OF ALL OUTSTANDING LOANS AS OF THE LAST DAY OF THE REPORTING PERIOD	\$ <u>-0-</u>

16 AFFIDAVIT

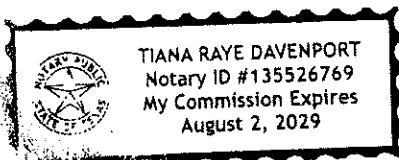

I swear, or affirm, under penalty of perjury, that the accompanying report is true and correct and includes all information required to be reported by me under Title 15, Election Code.

Charles Thomas Corbin

Signature of Campaign Treasurer

AFFIX NOTARY STAMP / SEAL ABOVE

Sworn to and subscribed before me, by the said Charles Thomas Corbin, this the 07 day of January, 20 26, to certify which, witness my hand and seal of office.

Tiana Davenport
Signature of officer administering oath

Tiana Davenport
Printed name of officer administering oath

Notary Public
Title of officer administering oath

SUBTOTALS - GPAC

FORM GPAC
COVER SHEET PG 3

17 COMMITTEE NAME

South East Republican Club

18 Filer ID (Ethics Commission Filers)

00060036

19 SCHEDULE SUBTOTALS
NAME OF SCHEDULE

SUBTOTAL
AMOUNT

1. ☐ SCHEDULE A1: MONETARY POLITICAL CONTRIBUTIONS

\$

2. ☐ SCHEDULE A2: NON-MONETARY (IN-KIND) POLITICAL CONTRIBUTIONS

\$

3. ☐ SCHEDULE B: PLEDGED CONTRIBUTIONS

\$

4. ☐ SCHEDULE C1: MONETARY CONTRIBUTIONS FROM CORPORATION OR LABOR ORGANIZATION

\$

5. ☐ SCHEDULE C2: NON-MONETARY (IN-KIND) CONTRIBUTIONS FROM CORPORATION OR LABOR ORGANIZATION

\$

6. ☐ SCHEDULE C3: MONETARY SUPPORT FROM CORPORATION OR LABOR ORGANIZATION

\$

7. ☐ SCHEDULE C4: NON-MONETARY SUPPORT FROM CORPORATION OR LABOR ORGANIZATION

\$

8. ☐ SCHEDULE D: PLEDGED CONTRIBUTIONS FROM CORPORATION OR LABOR ORGANIZATION

\$

9. ☐ SCHEDULE E: LOANS

\$

10. ☒ SCHEDULE F1: POLITICAL EXPENDITURES MADE FROM POLITICAL CONTRIBUTIONS

\$ 193.46

11. ☐ SCHEDULE F2: UNPAID INCURRED OBLIGATIONS

\$

12. ☐ SCHEDULE F3: PURCHASE OF INVESTMENTS MADE FROM POLITICAL CONTRIBUTIONS

\$

13. ☐ SCHEDULE F4: EXPENDITURES MADE BY CREDIT CARD

\$

14. ☐ SCHEDULE I: NON-POLITICAL EXPENDITURES MADE FROM POLITICAL CONTRIBUTIONS

\$

15. ☐ SCHEDULE K: INTEREST, CREDITS, GAINS, REFUNDS, AND CONTRIBUTIONS RETURNED TO FILER

\$

POLITICAL EXPENDITURES MADE FROM POLITICAL CONTRIBUTIONS

SCHEDULE F1

EXPENDITURE CATEGORIES FOR BOX 8(a)

Advertising Expense
Accounting/Banking
Consulting Expense
Contributions/Donations Made By
Candidate/Officeholder/Political Committee
Credit Card Payment

Event Expense
Fees
Food/Beverage Expense
Gift/Awards/Memorials Expense
Legal Services

Loan Repayment/Reimbursement
Office Overhead/Rental Expense
Polling Expense
Printing Expense
Salaries/Wages/Contract Labor

Solicitation/Fundraising Expense
Transportation Equipment & Related Expense
Travel In District
Travel Out Of District
Other (enter a category not listed above)

The Instruction Guide explains how to complete this form.

1 Total pages Schedule F1: <div style="text-align: center;">1 of 1</div>	2 FILER NAME <div style="text-align: center;">South East Republican Club</div>	3 Filer ID (Ethics Commission Filers) <div style="text-align: center;">00066036</div>
4 Date <div style="text-align: center;">07/01/2025</div>	5 Payee name <div style="text-align: center;">U.S. Post Office</div>	
6 Amount (\$) <div style="text-align: center;">\$117</div> <div style="margin-top: 5px;"> <input type="checkbox"/> Expenditure from corporate funds </div>	7 Payee address; City; State; Zip Code <div style="text-align: center;">756 N. Main Street, Mansfield, TX 76063</div>	
8 <div style="text-align: center;">PURPOSE OF EXPENDITURE</div>	(a) Category (See Categories listed at the top of this schedule) <div style="text-align: center;">Other Post Office Box Rental 6 months</div>	(b) Description <div style="margin-top: 5px;"> <input type="checkbox"/> Check if travel outside of Texas. Complete Schedule T. <input type="checkbox"/> Check if Austin, TX, officeholder living expense </div>
9 Complete <u>ONLY</u> if direct expenditure to benefit C/OH		
Date	Candidate / Officeholder name	
Payee name	Office sought	
Office held		

Date	Candidate / Officeholder name	
Payee name	Office sought	
Office held		

Date	Candidate / Officeholder name	
Payee name	Office sought	
Office held		

Date	Candidate / Officeholder name	
Payee name	Office sought	
Office held		

Date	Candidate / Officeholder name	
Payee name	Office sought	
Office held		

ATTACH ADDITIONAL COPIES OF THIS SCHEDULE AS NEEDED



AFFIDAVIT FOR COMMITTEE: ELECTRONIC FILING EXEMPTION

An exemption affidavit must be submitted with each paper report.

A campaign treasurer of a political committee that has accepted more than \$20,000 in political contributions or made more than \$20,000 in political expenditures in any calendar year must file all subsequent reports electronically.

Filer name <u>South East Republican Club</u>	Account # <u>00060036</u>
---	------------------------------

OFFICE USE ONLY

Date Received RECEIVED JAN 13 2026 Texas Ethics Commission
Date Hand-delivered or Date Postmarked
Date Processed
Date Imaged

1. I swear or affirm that the political committee of which I am the campaign treasurer has not accepted more than \$20,000 in political contributions or made more than \$20,000 in political expenditures in a calendar year.
2. I further swear or affirm that the political committee of which I am the campaign treasurer does not use computer equipment to keep current records of political contributions, political expenditures, or persons making political contributions to the committee.
3. I further swear or affirm that no person acting as the committee's agent or consultant, and no person with whom the committee contracts, uses computer equipment to keep current records of political contributions, political expenditures, or persons making political contributions to the committee.
4. I further swear or affirm that I understand that I am required to file the committee's campaign finance reports electronically if the committee, the committee's agent or consultant, or a person with whom the committee contracts exceeds \$20,000 in political contributions or political expenditures in a calendar year, or uses computer equipment to keep current records of political contributions, political expenditures, or persons making political contributions to the committee.
5. I am filing this affidavit with the General-Purpose Campaign Finance Report report due on 01/15/2026.

I understand that this affidavit is required to be filed with *each* campaign finance report for which the committee is claiming an exemption from electronic filing.

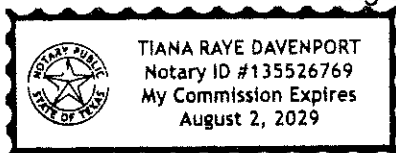

[Signature]
Signature of Campaign Treasurer

NOTARY STAMP / SEAL

Sworn to and subscribed before me by Charles Thomas Corwin this the 07 day of January 2026, to certify which, witness my hand and seal of office.

[Signature]
Signature of officer administering oath

Tiana Davenport
Print name of officer administering oath

Notary Public
Title of officer administering oath

**FILERS WHO ARE EXEMPT FROM THE ELECTRONIC FILING REQUIREMENT
ARE STILL REQUIRED TO FILE CAMPAIGN FINANCE REPORTS ON PAPER**



PRESS FIRMLY TO SEAL

PRESS FIRMLY TO SEAL

PRIORITY MAIL
FLAT RATE ENVELOPE
POSTAGE REQUIRED



TY®

Retail

P

US POSTAGE PAID

\$11.90

Origin: 76063
01/07/26
4856050063-7

Expected delivery

Domestic delivery

USF

Limi

Whe

*Insuran
Domesti

** See In...

RECEIVED

JAN 13 2026

Texas Ethics Commission

PRIORITY MAIL®

destinations.

0 Lb 2.30 Oz

RDC 03

DELIVERY DAY: 01/12/26

** See In...

B100

verage.

SHIP TO:

PO BOX 12070
AUSTIN TX 78711-2070



Package Pickup,
QR code.

FLAT RATE

ONE RATE ■ AN

USPS TRACKING® #

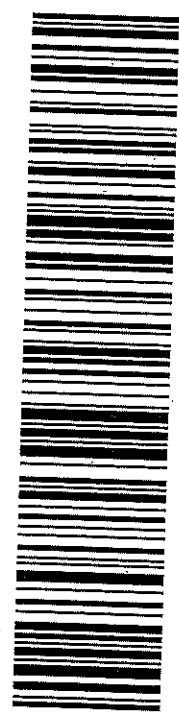

9505 5136 3652 6007 5576 39

TRACKE

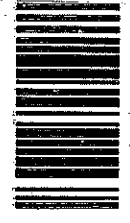

PS00001



TOM CORBIN
Attorney
P.O. Box 237
MANSFIELD, TEXAS 76063

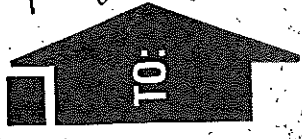

Texas Ethics Commission
P.O. Box 12070, Capital
Austin TX 78711-207

FROM: